

T-Mobile®  
webConnect®



Start Guide

## Table of Contents

Welcome .....	3
Get Started .....	4
Installation & Setup .....	7
T-Mobile Broadband .....	9
Wi-Fi .....	15
Virtual Private Network (VPN) .....	18
Additional Information .....	22

## Welcome

Congratulations on your purchase of the T-Mobile® webConnect Rocket™ USB Laptop Stick with T-Mobile webConnect® (also referred to as the webConnect Rocket). Your webConnect Rocket allows you to experience faster than 3G data transfer speeds wherever T-Mobile has HSPA+ network coverage.\*

This guide provides you with information to get started. If you need additional information, please refer to one of the following options:

- On the T-Mobile webConnect Manager screen, click **Help > Help**.
- Visit **www.t-mobile.com**.
- Call **1-800-937-8997** for general assistance or call **877-822-SPOT** for assistance with T-Mobile HotSpot or Wi-Fi.

\* HSPA+ is not available in all markets. Your device will still work wherever service is available on T-Mobile's nationwide 3G network.

## Get Started

### Before you begin

You will need the following:

- A webConnect Rocket
- A T-Mobile webConnect Data Plan
- A Subscriber Identity Module (SIM) card
- A computer with the following minimum requirements (see below)

### Computer requirements

You will need a computer with the following minimum requirements:

	Windows XP®	Windows Vista®
Processor	300 MHz	1 GHz
RAM	256 MB	1 GB
Hard Drive Space	60 MB	60 MB
Internet Explorer	IE 5.5	IE 7
OS Service Pack	Service Pack 1 (or later)	Service Pack 0, 1

	Windows 7	MAC 10.4	MAC 10.5
Processor	1 GHz 32-bit 1 GHz 64-bit	POWER PC G3	876 MHz
RAM	1 GB	256 MB	512 MB
Hard Drive Space	160 MB	3 GB	9 GB
Internet Explorer	IE 8.0	Safari	Safari
OS Service Pack	Service Pack 0		

### T-Mobile webConnect Data Plans

T-Mobile's webConnect Data Plans allow you to connect to the Internet through T-Mobile's Broadband and HotSpot Networks.

- **Using webConnect for Broadband HSPA+, 3G, 2G Access**  
T-Mobile's rapidly expanding 3G network provides faster data transfer rates than 2G (also known as EDGE/GPRS) and even faster data transfer rates than 3G where T-Mobile HSPA+ is available. If 3G is not available, the webconnect Rocket will automatically try to find T-Mobile's 2G network. The plans also provide global roaming access in many countries where T-Mobile coverage is available and roaming agreements are in place.

- **Using T-Mobile HotSpot Network for Wi-Fi Access**

The webConnect Manager also allows you to control your connections to home, work, and public Wi-Fi networks. The included T-Mobile HotSpot account provides access to Wi-Fi in numerous locations worldwide. With your webConnect Data Plan, you have unlimited Wi-Fi access at nearly 10,000 locations in the T-Mobile HotSpot Network, including Starbucks, Barnes & Noble Bookstores, select Hyatt Hotels & Resorts, Red Roof Inns, Sofitel and Novotel Hotels, the airline clubs of American®, Delta, United®, and US Airways®, Dallas Fort Worth International Airport, Los Angeles International Airport, San Francisco International Airport, and other airports. You can also use your account at thousands of roaming locations worldwide (roaming charges may apply). For a complete listing of T-Mobile HotSpot Network locations, at the main webConnect Manager screen, click the **Wi-Fi** tab, then click **Tools > HotSpot Locator**.

International broadband use requires international service activation; usage does not apply toward monthly data allowance. International rates apply.

**NOTE:** For data services, you may need to wait up to 24 hours for the service to be activated. By activating service, you acknowledge that you have read and agreed to the Terms and Conditions of the Service Agreement.

## Installation & Setup

### Insert SIM card

Your Subscriber Identity Module (SIM) card identifies you to the wireless network. You will not be able to connect to the network without your SIM card.

1. Remove the SIM card cover.
2. Insert the SIM card into the SIM card slot with the golden contacts facing down and the notched corner facing out.
3. Replace the SIM card slot cover.



## Insert memory card

Your webConnect Rocket supports a microSDHC™ memory card (not included with your purchase).

**NOTE:** Do not remove your memory card while it is in use. Removing the memory card while in use may corrupt the data stored on your memory card and damage the memory card or your WebConnect Rocket.

Slide the memory card into the memory card slot with the golden contacts facing the back side of your webConnect Rocket.



## Install the webConnect Manager

Connect your WebConnect Rocket to the USB port of your computer. For Windows®, the webConnect Manager installs automatically.

For MAC, follow the instructions below:

1. Insert your WebConnect Rocket into your laptop. A virtual webConnect Mgr CD-ROM opens on your desktop.
2. Double-click the **webConnect Mgr CD-ROM**.
3. Open the MacUsersStartHere.html file for instructions on how to install the webConnect Manager software on your MAC.

## T-Mobile Broadband

### Connect to T-Mobile Broadband

You do not need to add a profile or change settings to connect to T-Mobile Broadband.

1. Make sure your SIM card is in your WebConnect Rocket.
2. Insert your WebConnect Rocket into your laptop.
3. Open the webConnect Manager.
4. Click the **T-Mobile Broadband** tab. Your WebConnect Rocket will then scan the area for available networks.
5. Click **Connect**.

### Connect to other networks

To connect to another network, you must first create a profile for that network. Consult with your IT administrator if needed for applicable settings. To create a profile:

1. Open the webConnect Manager and click the **T-Mobile Broadband** tab.
2. Click **Tools > Profiles**. The Profiles screen opens.
3. At the Profiles screen, click **Add**.
4. Click **Broadband** and then click **Add**.

5. Select the profile of the network you would like to add or select **Create Customer Profile** if you want to create a profile for a network that is not listed.
6. Click **Next**.
7. On the Broadband screen, configure your settings as needed and click **Next**.
8. On the IP Settings screen, configure your settings as needed and click **Next**.
9. On the General screen, configure the remainder of the settings for your profile and click **Finish**.

### Connect to other networks

Connecting to other broadband networks may incur roaming charges.

1. Open the webConnect Manager and click the **T-Mobile Broadband** tab.
2. Click **Tools > Profiles**.
3. Click the network that you want to connect to.
4. Click **Connect**.

### Send and receive text messages

When you are connected to broadband, you can receive and send short text messages to mobile phones or to another device that supports text messaging.

### Read text messages

When you receive a new text message, the webConnect Manager displays the **Envelope**  icon with a red star on the main Broadband screen.

1. Open the webConnect Manager and click the **T-Mobile Broadband** tab.
2. Click the **Envelope**  icon.
3. Make sure **Inbox** is selected.
4. Double-click the message you want to read.





### Write and send text messages

1. Open the webConnect Manager and click the **T-Mobile Broadband** tab.
2. Click the **MSG**  button.

Separate charges apply to send/receive domestic/international text messages.

3. Click **New** to open the new message screen.
4. At the **To** line, type the destination phone number OR click **To** to open the address book to select a contact saved in your address book.
5. Type your message and click **Send**.

### Manage text messages

- Click  or click **File > Folders > New Folder** to create a new folder to store messages.
- Click  or click **File > Folders > Delete Folder** to delete a folder (and all the messages it contains).
- Click  or click **Edit > Move to Folder** to move the selected message to another folder.
- Click  or click **Edit > Copy to Folder** to place a copy of the selected message in another folder.

### Check usage data

Your data plan includes a monthly allowance of 3G and 2G data usage. A per megabyte overage charge applies if you exceed your monthly data allowance. You will receive free text messages from T-Mobile if you are approaching or have reached your monthly data usage allowance. Wi-Fi usage through T-Mobile HotSpot as well as any other open Wi-Fi connection is unlimited and does not count against your monthly data allowance.

To track your data usage by going to the webConnect Manager:

1. Open the webConnect Manager and click the **T-Mobile Broadband** tab.
2. Click **Usage meter**.
3. Select the billing period start date. You can get your billing start date by going to <http://my.t-mobile.com>.

## Check software updates

You may receive periodic updates to your webConnect Manager software. You can also manually check for updates.

### Check updates manually

1. Open the webConnect Manager and click the **T-Mobile Broadband** tab.
2. Click **Tools > Settings**.
3. Click the **Updates** tab.
4. Click **Update Now** to check for available updates. If you have updates available, a screen opens listing the updates. Select the updates you want and click **Download**.

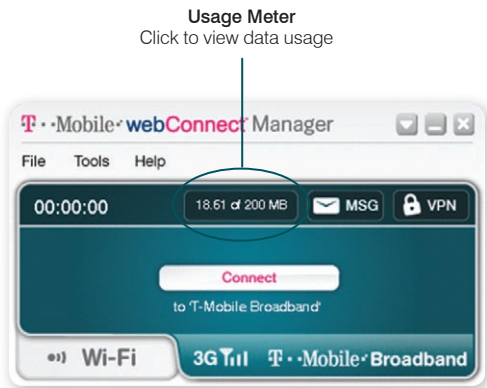

## Wi-Fi

You can get Wi-Fi Internet access on the T-Mobile HotSpot Network by connecting to T-Mobile Wi-Fi Network. Internet access at these T-Mobile HotSpot and partner locations is included in your webConnect Data Plan.

### Connect to T-Mobile HotSpot roaming locations

You can use your T-Mobile HotSpot username and password at thousands of roaming locations around the world (additional charges may apply). To see a list of these locations, click the **Wi-Fi** tab and click **Tools > HotSpot Locator**.

1. Make sure that you are at a T-Mobile HotSpot Network location.
2. Open the webConnect Manager on your laptop.
3. Click the **Wi-Fi** tab to scan for available networks.
4. Click **Connect**.

You will be prompted to type your username and password to your T-Mobile HotSpot account. Your username is your 10-digit phone number and your default password is the last four digits of your Social Security number.

5. Type your username and password. When you have successfully logged in, the T-Mobile HotSpot welcome screen opens.

#### TIPS:

The default password for a corporate customer is the last four digits of the tax ID.

If you forget your username (phone number), open the webConnect Manager and click **Tools > Network Info > Broadband in Connection Manager**. Your username is your 10-digit phone number.

If you forget your password, you can open a browser while at a T-Mobile HotSpot location and click **Account Management**. Follow instructions on the screen to reset your password. When done, open the webConnect Manager and click the **Wi-Fi** tab. Click **Tools > User Credentials**. Enter your username and the new password and click **OK**.

If you want to auto-save your username and password, you can open the webConnect Manager and click the **Wi-Fi** tab then click **Tools > User Credentials**. Type your username and password and select **Store this password for future logins**.

When downloading large files like software updates and movies, use your nearest HotSpot access point or home Internet connection to avoid going over your usage allowance.

#### Connect to other Wi-Fi Networks

The webConnect Manager comes pre-loaded with settings for the T-Mobile HotSpot Network, but connecting to other Wi-Fi networks is as easy as connecting to T-Mobile HotSpot.

1. Make sure that you are at a location with Wi-Fi access.
2. Open the webConnect Manager and click the **Wi-Fi** tab.
3. Click **Networks** to display a list of available Wi-Fi networks.
4. Click **Connect** for the desired network.

#### NOTES:

The webConnect Manager will attempt to automatically connect to any pre-defined networks set in your network profile settings or display the last network connection that you made.

Before you connect to a Wi-Fi network, you should confirm with its operator if you will need any additional settings to connect. For example, if you are trying to connect to your work Wi-Fi network, you should check with your IT administrator for the correct settings.

## Virtual Private Network (VPN)

Virtual Private Networks (VPN) are extensions of private networks that you can access over a public network, such as the Internet. For example, a large company may implement a VPN so that employees can connect to the corporate network from remote locations over the Internet. To connect to a VPN, you may need special software or settings on your laptop. Please check with your IT administrator for software or settings needed to connect to VPN.

The webConnect Manager currently supports VPN clients from the following vendors:

- Microsoft®
- Cisco Systems®
- Nortel Networks Limited®
- Check Point Software Technologies Ltd.®
- NetMotion Wireless

## Configure VPN

You need to configure VPN settings before connecting to VPN.

1. Open the webConnect Manager and click the **T-Mobile Broadband** tab.
2. Click **Tools > Settings**.
3. Click the **VPN** tab.
4. Click **Use existing VPN profile**.
5. Select the VPN client and profile from the drop-down boxes.
6. Click **OK**.

You should see the **VPN** icon appear on the webConnect Manager screen. The next time that you connect to broadband, the VPN client automatically launches.

## Connect to VPN manually

If you have configured VPN, you will see the **VPN** icon on the webConnect Manager screen.

1. At the webConnect Manager screen, click the **VPN** icon.
2. Sign in to your VPN account to connect.

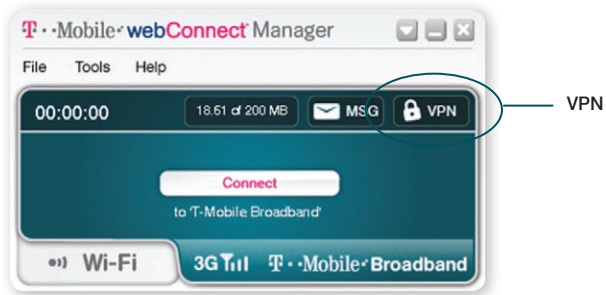

## Additional Information

**Data Plans:** You will be charged for all data sent by or to you through the network, regardless of whether received. Data speed is variable and may be impacted by network conditions and traffic. There is no additional charge for HSPA+ usage. Your data session, plan or service may be slowed, suspended, terminated or restricted if you use your service in a way that interferes with or impacts our network or ability to provide quality service to other users, if you roam for a significant portion of your usage, or if you use a disproportionate amount of bandwidth during a billing cycle. You may not use your plan or device for the prohibited uses listed in your data plan terms. T-Mobile is not responsible for any third party content or Web site you access using your device. T-Mobile cannot guarantee the security of any Internet communications. See your data plan terms at [www.T-Mobile.com](http://www.T-Mobile.com) for additional details. If you access the T-Mobile HotSpot Network, your use is subject to the T-Mobile HotSpot Terms and Conditions, available at [hotspot.t-mobile.com](http://hotspot.t-mobile.com).

**webConnect:** Overage charges apply; partial megabytes rounded up for billing. webConnect device required; not voice-capable. Device may not be shared in any manner, including use with a network or more than one computer or other device. Device requires a specific data plan; if you do not have the right plan, you may not be able to use data services. Domestic roaming not possible. Roaming charges may apply to use via non T-Mobile owned Wi-Fi networks.

**International use** requires international service activation; usage does not apply toward webConnect plan limit. International rates apply.

**Coverage:** Service not available everywhere; HSPA+ and 3G coverage available in certain markets. See brochures, and **T-Mobile's Terms and Conditions (including arbitration provision)** at [www.t-Mobile.com](http://www.t-Mobile.com), for coverage maps, rate plan information, charges for features and services, and restrictions and details. T-Mobile and the magenta color are registered trademarks of Deutsche Telekom AG. webConnect is a 2010 trademark and webConnect Rocket is a trademark of T-Mobile USA, Inc.  
©2010 T-Mobile USA, Inc.



